

Face & Body Shaver

## MXBS-100

### Instruction Manual

Thank you for purchasing this Maxell product.

Before use, make sure to read this Instruction Manual and use the product correctly and safely. Please take reference to the attached appendix if there is any.

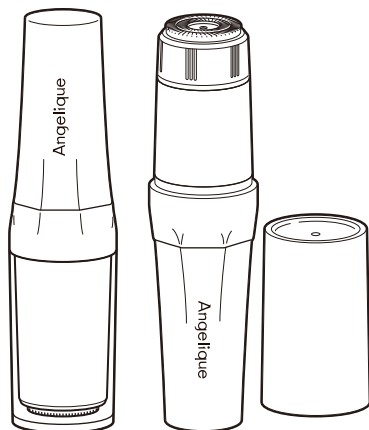

### Table of contents

<b>1</b>	Contents of the package .....	p. 2
<b>2</b>	Introduction .....	p. 2
<b>3</b>	Safety precautions .....	p. 3
<b>4</b>	Name of each part .....	p. 6
<b>5</b>	Preparation before use .....	p. 7
<b>6</b>	How to use .....	p. 9
<b>7</b>	Maintenance .....	p. 11
<b>8</b>	Storage .....	p. 14
<b>9</b>	Troubleshooting (When problems arise) ..	p. 14
<b>10</b>	Warranty and after-sales service ...	p. 15
<b>11</b>	Consumable parts / separately sold parts .....	p. 15
<b>12</b>	Specifications .....	p. 15

# 1 Contents of the package

Main Unit

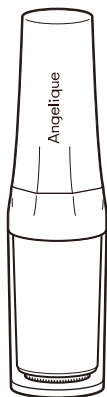

Cleaning Brush

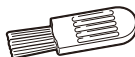

User Manual  
(This Document)

## 2 Introduction

### About the user manual

- This Instruction Manual may be subject to change without prior notice.
- In order to improve the product, external appearance or part of the specifications may be subject to change without prior notice.
- Unauthorized duplication of part or all of this Instruction Manual without permission is prohibited except for the case of personal use. In addition, do not reprint this Instruction Manual without permission.

### Disclaimer (See the warranty card for details of the warranty.)

- Maxell shall not be responsible for any damage caused by fire, earthquakes, action of a third party, any accidents, intended or unintended misuse or other usage under abnormal conditions.
- The warranty stated in the warranty card is all, and all explicit and implicit contents not stated in the warranty card are not covered.
- We are not responsible for any damage caused by using the product in ways other than those described in this instruction manual.
- This product is not being designed to be any equipment or device which could be concerned with human life such as medical device, nuclear device, astronomical device, transportation device etc., nor equipment or devices which requires high reliability. In case this product is used for the above equipment and/ or systems, Maxell do not responsible for any injuries or fire accident cause by the failure of this product.
- We are not responsible for any use outside of Japan.

### 3 Safety Caution

Please strictly follow.



#### Warning

If it is handled incorrectly, it is assumed that the user may suffer death or serious injury\*1.



#### Caution

If it is handled incorrectly, it is assumed that the user may suffer minor injury\*2 or there is a possibility that property damage\*3 may occur.

\*1: Severe injury is indicated by those that have after effects such as blindness, injury, burns (high temperature burns/ low temperature burns, chemical burns), electric shock, fracture, poisoning, etc. and those requiring hospitalization or long-term regular hospital visits for treatment.

\*2: Minor injury refers to hurt, burnt, electric shock, etc. which do not result in hospitalization or long-term follow-up consultation.

\*3: Property damage refers broad damages to houses or properties and domestic animals/ pets.

KEY		⊘ Stands for prohibited actions when handling the product. Details will be illustrated inside or next to the symbol or with written description next to it.
		△ Stands for caution to fire, explosion, high temperature when handling the product. Details will be illustrated inside the symbol.
		● Stands for instruction which must be followed. Details will be illustrated inside or next to the symbol or with written description next to it.



## WARNING



#### Do not disassemble or modify

It may cause fire or injury.



#### Do not use if the blade is damaged or deformed or the internal structure is exposed

It may cause injury.



#### Do not let children use it alone and keep it out of reach of children

It may cause injury.



#### Do not use in a moving car

It may cause accident.



#### Do not put the main unit or dry cell batteries in the fire

It may cause accident or injury.



# CAUTION



**Do not use if you have a rash caused by makeup, a rash caused by a razor, or have an allergic predisposition**

It may damage your skin.

---



**Do not use on acne, pimples or scratches**

It may damage your skin.

---



**This device is dedicated to remove unwanted hair on face, nape, armpits, arms, legs, hands and fingers. Do not use for head hair etc.**

It may damage your skin.

---



**Do not press the blade hard against the skin**

It may damage your skin.

---



**Do not press the blade hard or apply a strong impact**

The blade may be deformed and cause damage to the skin.

---



**Do not use it for commercial purposes or share it with family members or others**

It may cause infections.

---



**Do not shave with only a part of the outer blade or put your fingers or nails on the outer blade during use**

It may damage the outer blade and damage your skin.

---



**Check the blade for any damage or deformation before use**

It may damage your skin.

---



**Be sure to attach the cap after use**

It may damage the outer blade and damage your skin.

---



## CAUTION



**Failure to observe the following may cause the battery to overheat, liquid leak, or rupture, resulting in injury or malfunction**

- Use the dry cell battery correctly according to the indication.
  - Be sure to switch off after use.
  - Regularly check for dry cell battery leaks.
  - When replacing the dry cell battery, use a new dry cell battery that is within the recommended expiration date.
  - If the product is not used for more than a month, remove the dry cell battery.
  - Do not let the + and – terminals of the removed dry cell battery come into contact with metal.
-

## 4 Name of Each Part

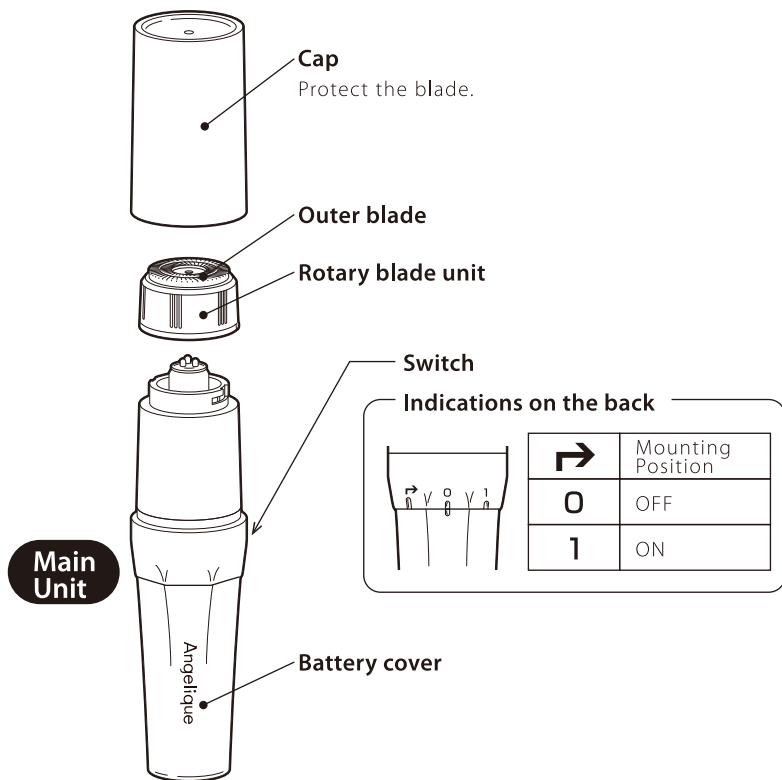

## 5 Preparation Before Use

Prepare a new AA alkaline battery (LR6).

※Maxell "VOLTAGE" alkaline dry cell battery recommended.

### Precautions when using dry cell batteries

- Do not use batteries with liquid leaked.
- Do not use batteries other than alkaline dry cell batteries (AA).
- Insert + and – terminals correctly according to the display on the main unit.
- Use dry cell batteries that is within the recommended expiration date.
- When the battery is exhausted, remove it immediately.
- Dispose of used dry cell batteries in accordance with local regulations.

#### 1 Remove the battery cover

Pull it out by turning it until the concave mark on the battery case comes to the mounting position (➡) of the main unit.

Remove the battery cover by holding the main unit.

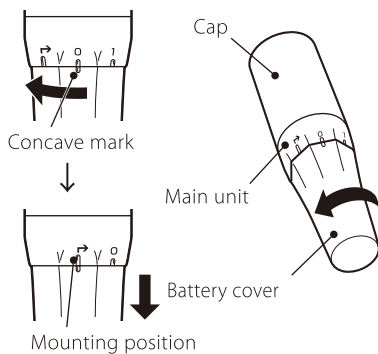

#### 2 Insert the AA alkaline dry cell battery (LR6) according to the orientation of the main unit display

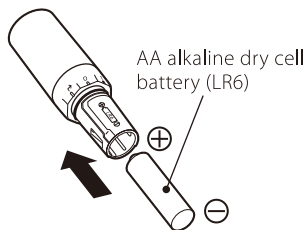

### 3 Attach the battery cover

Align the concave mark on the battery cover with the ↑ position of the main unit, insert it, and turn it until it reaches the 0 position on the main unit.

If it is not attached securely, water may ingress into the main unit when washing with water, causing a malfunction.

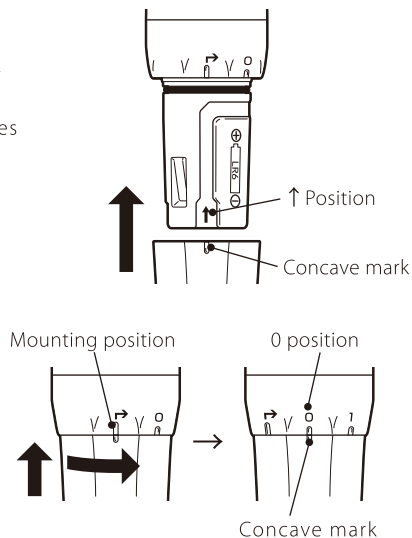

## Battery Life

**When used twice a week (5 minutes each time), the dry cell battery will last for about 1 month**

(using Maxell "VOLTAGE" alkaline dry cell batteries)

※The number of usage times may decrease depending on the conditions of use such as hair thickness, force applied to the skin, care method, and ambient temperature.



## 6 How to Use

### Caution

#### Trim long hair first

Hair may get entangled in the blade and cause equipment failure.

- For the first time use, please apply it lightly and try it little by little.
- The outer blade may become warm, however there is no problem in use.

**1 Remove the cap and turn the switch to position 1 (ON)**

**2 Lightly press the outer blade against the skin and slide it in a circular motion**



**3 Turn the switch to position 0 (OFF) after use**

**4 Remove hair debris from the rotary blade unit**

**5 Cover with a cap and store in a dry place**

## How to shave well

- Stretch the skin so that it does not sag, and move it slowly in circular motion against the direction of hair growth.
- Do not shave long hair at once, shave it little by little or cut it in advance.

### Armpit

From top to bottom



### Leg

From bottom to top

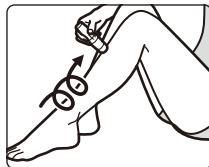

### Arm

From outside to inside



### Hand & Fingers

From outside to inside

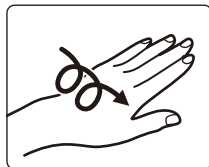

### Nape

From bottom to top

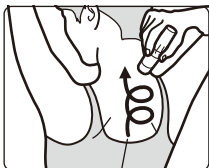

## CAUTION

**When using on armpits, thighs, upper arms, or other areas where the skin is thin and delicate, stretch the skin so that it does not sag and lightly apply the outer blade to gently shave the area.**

If you press the blades too hard or move it quickly at once, it may hurt the skin.

**Depending on the condition of your skin, the blade cause irritation or rough skin. If you notice any abnormalities on your skin, please stop use.**

Continued use may worsen the symptoms of rough skin.

## ■ You may apply foaming soap

Use commercially available foaming soap for smoother your skin and smooth shaving.

### Caution

**Do not use cosmetic products such as shaving creams, gels or emulsions**

It may cause blockage or malfunction of the outer blade.

- 1 **Apply the foaming soap to the area to be shaved.**
- 2 **Apply the blade more gently to the skin than dry shave, and slowly shave against the direction of hair.**
- 3 **After use, remove the rotary blade unit and be sure to wash it with water to wash away the soap residue.**

For how to wash the product with water, refer to "Maintenance".

If soap residue remains, it may cause the device to malfunction, such as not working. And it will reduce the sharpness and life of the blade.

- 4 **After cleaning, cover with a cap and store in a dry place.**

## 7 Maintenance

### Caution

**Do not wash with water while the battery cover is removed**

Water may ingress into the main unit and cause malfunction.

**Do not use excessive force when holding the outer blade**

It may damage the outer blade and hurt your fingers.

**Do not put it in water**

It may cause malfunction.

**Do not wipe with alcohol, benzene, thinner, etc**

It may cause deformation or discoloration.

## ■ To maintain sharpness

- Be sure to clean with the brush after use.
- Rinse with water and clean with brush each time.  
Apply shaver oil(sold separately) to the outer blade once a week.

1 Turn the battery cover back to the position 0 (OFF) to turn off the power

2 Turn the rotary blade unit to the counter-clockwise and remove it

When removing the rotary blade unit, do not hold the battery cover.

Switch is 0 position (OFF)

3 Remove hair debris from the rotary blade unit and main unit

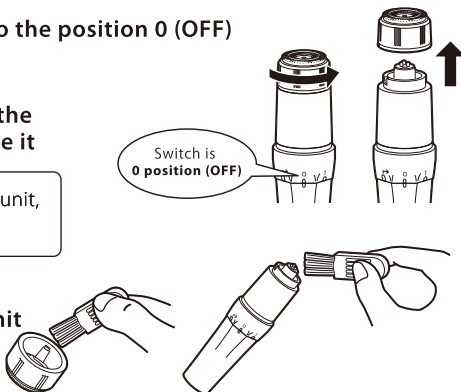

## ■ The rotary blade unit and main unit can be washed with water.

① After cleaning with the brush, wash away hair debris from the rotary blade unit and main unit.

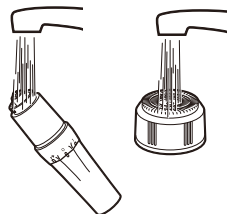

### When hair debris and dirt are hard to remove

After washing with water once, apply a small amount of kitchen detergent (neutral) to the rotary blade unit, turn the switch to position 1 (ON), lather the entire blade surface evenly for 20 seconds, and then wash again with water to remove hair debris and dirt. It will become easier to remove.

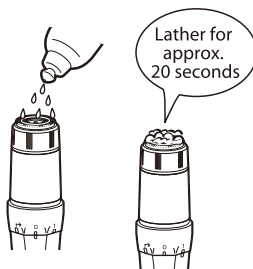

② **Wipe off the water droplets on main unit  
main unit and let it dry**

If the rotary blade unit is removed from the main unit, it dries quickly.

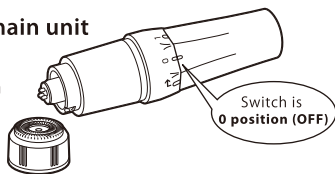

**Caution**

**Do not shake the body to drain excess water**

**Do not dry in direct sunlight or high temperature**

It may cause deformation, discoloration, or malfunction.

**Do not dry with equipment such as dryers and fan heaters**

It may cause the blade to be deformed or malfunction.

③ **After drying, shaver oil (sold separately) to the  
outer blade**



④ **Attach the rotary blade unit to the main unit, let it idling for  
to 2 to 3 seconds, and lightly wipe the outside surface with a  
tissue etc.**

4 **After cleaning, align the convex part of  
the rotary blade unit with the groove of  
the main unit, and turn the rotary blade  
unit to the clockwise to attach it**

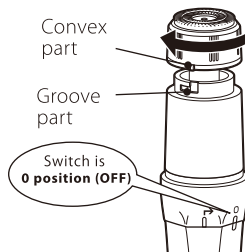

5 **After cleaning, cover with a cap and store in a dry place**

## 8 Storage

Cover with a cap and store in a place with low humidity and dust.

### Caution

#### **Do not place it in direct sunlight or high temperature**

It may cause deformation, discoloration, or malfunction.

#### **Do not place in high humidity places such as bathroom**

It may cause a malfunction due to condensation.

## 9 Troubleshooting (When problems arise)

Phenomenon	Cause	Solution
It does not operate	The dry cell battery is inserted in the wrong direction	Check the battery orientation⊕⊖ and reinsert it
	Dry cell battery is exhausted	Replace with a new alkaline dry cell battery
	The rotary blade unit is not firmly attached	Reattach the rotary blade unit
	Hair debris has accumulated	Remove hair debris
• Does not shave smoothly • Usage time is less • Stops during use • Rotation is weak	Hair debris has accumulated	Remove hair debris
	The outer blade surface is out of oil	Apply shaver oil (sold separately)
	The blade is worn	Replace with a new rotary blade unit
	Dry cell battery is exhausted	Replace with a new alkaline dry cell battery
Wrong type of dry cell battery	Replace with a new alkaline dry cell battery	
There is a strange noise during operation	The outer blade surface is out of oil	Apply shaver oil (sold separately)
	The blade is worn or damaged	Replace with a new rotary blade unit
Hair debris splatters	Hair debris is accumulated	Remove hair debris
The smell got stronger	Insufficient drying after washing with water	After washing with water and dry well. If it smells, please wash it with kitchen detergent (neutral)

## 10 Warranty and After-Sales Service

### ■ The warranty

Be sure to keep the warranty card with the receipt at the time of purchase.

### ■ Supply period of repair parts

We supply the repair parts (product's function maintenance parts) for this face and body shaver valid for 6 years after product discontinuation.

## 11 Consumable Parts / Separately Sold Parts

Rotary blade units and shaver oil are available.

- **The rotary blade unit is a consumable item. Please replace the rotary blade unit (sold separately) as soon as possible.**

The guideline for replacement is about once a year assume used twice a week(5 minutes each time) with proper use and maintenance.

**Please purchase the rotary blade unit and shaver oil at the Maxell official shop.**

Rotary blade unit KM-L02  
Shaver oil SP-01

<https://maxell-online.com/>



## 12 Specifications

Power supply / Voltage	Dry cell battery / DC1.5V
Types and number of dry cell batteries	AA alkaline dry cell battery (LR6) x 1
Weight	Approx. 85g (including dry cell batteries)
Accessory	Cleaning brush

### ■ Disposal

When disposing of this product, follow the instructions (local regulations) of each local government.